

Lawton Light!

Church Lawton Parish Magazine

February 2025

50p



*Then I heard the voice of the Lord saying,
“Whom shall I send? And who will go for
us?”*

And I said, “Here am I. Send me!”

Isaiah 6:v8



We really appreciate the support of our advertisers in the Lawton Light magazine. We produce 150 hard copies and it has a readership locally of 2.5 times that. It is available on our website and also on a Church Near You—so it reaches the world!

If you would like to advertise in Lawton Light please contact the editor Jane Baker on Telephone 01270 876363 or email: editor@allsaintschurchlawton.co.uk

MOORSIDE MEMORIALS
MONUMENTAL MASONS - CRAFTSMEN IN STONE

MONUMENTAL STONE MASONS
GRAVE DIGGERS & GROUNDS MAINTENANCE

- New Memorials • Renovation • Levelling • Turfing • Additional Inscriptions • Re-Guilding
- Regular Grave Maintenance Available •

A small family business caring for *your* family
- Staffordshire - Cheshire - Stoke -

For more information on the services we provide please call:
01260 295435 or 01782 522242
email: memorialman@outlook.com

Please Support our
Advertisers in Lawton Light

TEL: 01270 882097
144/146 Crewe Road, Alsager, Cheshire

JOSEPH EDWARDS & SONS

FAMILY FUNERAL DIRECTORS
SINCE 1882

TEL: 01782 775333
3 King Street, Kidsgrove, S-O-T

www.josephedwards.co.uk
24 hour personal service

LEESE MEMORIALS
Craftsmen In Stone

- Sensitive & Personal Attention
- Highest Quality Materials
- Individual Design Service
- Renovation Work
- Brochure on Request

(01782) 744433

HAROLD H. LEESE (A. BOULTON & SONS)
ST PETERS CLOSE (OFF BROOK ST) STOKE ST4 1LP

WILSONS FUNERAL DIRECTORS
(Ivan J Kirkham)

48 Cinderhill Lane
Scholar Green
Stoke-on-Trent

Tel: 01782-785937

LAWTON LIGHT! Who's Who at All Saints'?

Curate	Rev Sis. Heather Kemball	Mob:07473 355646
Lay Ministers	Margaret Cruxton**	Tel:01270 876366
	Bev Boulton**	Tel:01270 874491
Church Wardens	Jane Baker	Tel:01270 876363
	Bev Boulton	Tel:01270 874491
Dty. Church Warden	Paul Cruxton	Tel:01270 876366
Secretary PCC	Di Williams	Tel: 01260275271
Treasurer PCC	Yvonne Banks	Tel:01782 782571
Messy Church	Jackie Moss	Tel:01782 771067
Lawton Light!	Jane Baker	Tel:01270 876363
Musical Director	Margaret Cruxton	Tel:01270 876366

**** Members of our team are very pleased to visit you in your home, to listen to you, talk with you, and pray with you. Nothing is too trivial, and nothing is beyond the reach of God's love and grace.**

All you have to do is pick up the telephone and call.

We will be delighted to hear from you, and respond to your need.



**Please scan me to donate
to help maintain our
church**



February Letter

Dear friends,

One of the things I love about living in this country is that we have four distinct seasons. Of course, when I am scraping ice off my car to drive to an 8.30am service at church, I am a little less enthusiastic about winter, but even then the ice and snow can be very beautiful and they have a way of turning our landscape into a winter wonderland.



Winter in the UK, with its colder weather and reduced hours of sunlight, provides an opportunity both for our land, and also for ourselves to take things a little slower; to rest, to be restored; to plan and prepare for the warmer months ahead.

We can make plans for what we will grow in our gardens, we can

make decisions about future holidays or staycations, and I know many of us enjoy being creative – be it knitting, crochet, cross stitch, crafting or painting - which are a great way to fill the long winter evenings at home. The Christian calendar also has its seasons, and as we journey through Epiphany this month, we can see Lent on the horizon, which this year begins on 5th March.

During this period we have the opportunity to spend time in prayer, reflection and preparation, leading up to the celebration of Easter on 20th April. To help us, as we did last year, we will be having a Lent Course and Lent book, full details of which will appear in next month's magazine.

Coming back to this month of February, we very much hope you will be able to join us in church on Friday 21st February at 7pm for a Fish and Chip Supper and a Beetle Drive.

God bless,
Heather

Electoral Roll



Belong



Participate



Contribute

Come and join us!

Our church Annual Parochial Church Meeting (APCM) will be at All Saints' Church on **Sunday 13th April** following the 10.45am service

As part of our preparation for this meeting we have to revise our Church Electoral Roll – our official membership list. **This year there is a full revision of the Electoral Roll**

Anyone wishing their names to be included on our Electoral Roll and who, where necessary, has worshipped with us during the previous six months, is welcome to complete an application form for inclusion on the Electoral Roll **by 23rd March** The forms are available in church from 2nd March

A copy of the **revised Electoral Roll** will be displayed at All Saints'

Church on **30th March** for the two weeks leading up to the APCM.

The APCM is an important event in our church calendar. We review the year past, receive the accounts from our treasurer and elect our Churchwardens and members of the Parochial Church Council.

The APCM is an opportunity for us to thank God for what he has done and for what he continues to do in us and through us, and to express our appreciation to those who have done the bulk of the hard work in running our church.

Our Ministry team with the Churchwardens, Treasurer and PCC members have worked very hard this year and we would value your attendance on **13th April** as we present our reports to you and look towards to our future together.

Electoral Roll



Belong



Participate



Contribute

What's the Big Idea? An Introduction to the Books of the Old Testament: Job

'Why does God allow suffering?'

This is a frequently asked question of Christians, because we believe in a God who is both good and powerful and it is explored in the book of Job. This book is part of the wisdom literature, along with Proverbs, Ecclesiastes, and Song of Solomon.

Job was both wealthy and righteous, yet he experienced catastrophic suffering, losing all his wealth, children and health. This is portrayed as a result of Satan's challenge to God, testing whether Job's devotion to God was dependent on his circumstances or not.

The main body of the book (3:1-42:6) consists of dialogues between Job, his friends (Eliphaz, Bildad, and Zophar) and God. Job and his friends assume that God is almighty and just, and that no human being is wholly innocent. In the three cycles of speeches

they wrestle with the reasons for Job's suffering, remembering his morally upright character.

Finally, all are silenced by God, as He speaks Himself (chs 38-42). He points out that Job knows very little about the universe when he reflects on God's power. Job confesses his lack of understanding and weakness, but then goes on to confess his confidence and trust in God. This puts suffering in a right perspective. Job is not condemned, and the book ends with the restoration of his family and possessions.

The importance of this book is that it realistically addresses the painful questions of life, without offering simplistic answers. It focuses on how we should respond to suffering, rather than on why God allows suffering: 'Naked I came from my mother's womb, and naked I shall depart. The LORD gave and the LORD has taken away; may the name of the LORD be praised.' (1:21)

Canon Paul Hardingham continues his series on the books of the Bible,



9.00am
9th February
The lost Sheep



In Messy Church children and their parents/ carers have fun learning about the Christian faith together through different activities—crafts, cooking, games, songs...

If you would like to know more about Messy Church please contact Jackie Moss on 01782 771067 Or come along on the day.



Meru's Musings Remembered...

Teasers

High-Rise Elevator

A woman lives on the 30th floor of a high-rise apartment building. She hates taking the stairs. When leaving her home, she takes the elevator down to the lobby. When she returns, she takes the elevator to the 20th floor and walks up the remaining ten floors, except on rainy days. Why does the woman walk up the last ten floors every day except rainy days if she hates taking the stairs?

Broken Down and Bankrupt

A man is pushing his car to reach a hotel. When he arrives at the hotel, he discovers to his dismay, that he is now bankrupt. How did this happen?

-A woman walks into a room and presses a button. She loses 20 pounds in only a few seconds. How did she manage to lose the 20 pounds?

Latin quotations

Quieta non movere Let sleeping dogs lie.

Sapere aude Dare to be wise

Status quo The existing state of affairs.

Summum bonum The supreme good.

Summum ius summa iniria The more law, the less justice.

Tabula rasa A clean slate.

Terra firma Solid ground.

Latin names for plants, how many do you know?

Latin Name	Common Name
Rosa	Rose
Rosmarinus	Rosemary
Rudbeckia	Black eyed Susan, Coneflower
Rhamus	Buckthorn
Ribes	Flowering Currant
Rubus	Blackberry

Good Deeds

He who feeds strangers may have feed angels.

Deeds of kindness weigh as much as all the commandments.

Good and Evil:

It is better to see good than to hear bad.

See no evil in others and good in yourself, but the good in others and failings in yourself.

Waste no time arguing what a good man should be. Be one.

Gossip:

What's easy to say may be hard to bear.

What you don't see with your eyes, do not invent with your mouth.

The tongue has no bones-so its loose.

A tongue can be a dangerous weapon.

From a man's mouth you can tell what he is.

Gossip-natures telephone.

Meru Ullah

2025 Knitting Art Exhibition



Yes we've reached that time again and as the darker nights will soon be upon us it's get your knitting needles out time.

After a long hard think, we've settled on The Nativity Story as our theme for 2025

Again, using our tried and tested recipe of 4 inch knitted squares.



***Our recipe is :-
using double
knitting wool and
size 4 mm needles***

***(old number 8) cast on 25 stitches,
knit 45 rows then cast off, hopefully
you will have a 4 inch knitted square
-wonderful.***

As the darker nights creep upon us through the Autumn and Winter months, we would like as many people as possible to help with this project, so if you know anyone who can knit please ask them to help too.

All knitted squares can be left in church, given to a member of the congregation who will bring them into church, or give them to the person who delivers your Parish Magazine.

***We are now looking for squares in
any colour!***

Over the next few months, we will have updates on how the squares are coming along and what different colours we will be requiring to complete the project and of course more details about our exhibition date.

If you need further information at this time, please don't hesitate to ring Bev on 01270-874491

P.S Noah, Adam and Eve all hope this project is going to get as much support as they did.

Eco Church

All Saints' achieves Bronze Award!

Eco Church is a scheme run by A Rocha, UK equipping churches to care for God's creation through their worship, buildings, land, community engagement, and individual lifestyles.

The ethos behind Eco Church is underpinned by the National Church's goal to become Net Zero by 2030. In simple terms, Net Zero means, making no contribution to global warming. This is achieved by ensuring that the amount of fossil fuels (carbon) we put into the atmosphere is matched by the amount of carbon we take out of the atmosphere. Hence the term 'Carbon Neutral'.

The Diocese of Chester is committed to working towards the 2030 target and many of our churches have already taken steps to improve their carbon footprint by implementing improvements to their heating systems, recycling waste and planting trees etc.

The key to Eco Church scheme is all about balancing your carbon output. ways to offset your carbon consumption to 'balance your carbon books'.

A Rocha has an award scheme called [Eco Church](#), for churches who want to demonstrate that they are committed to becoming more Eco friendly. They have three awards, Bronze, Silver and Gold and offer help and guidance on achieving those awards.

All Saints' has been committed to caring for environmental issues over many years, through prayer, sermons, monthly recycling letter, recycling ink cartridges, tablet bubble packs, Olio food items and of course all the planting and caring in our churchyard, including a nature count.

As part of this process we have now twinned our toilet to support a toilet in Nepal and when we achieve our new inside toilet we will twin again!

As a church we are proposing two more ways to support our carbon footprint this year in learning and understanding more about our own carbon footprint and also supporting the world.

1. Below is the link to the Eco Audit [B1-Carbon-footprint-measurement-and-offset.pdf](#)

2. Supporting Earth Hour on the 22nd March 8.30pm to 9.30pm— [Join the Biggest Hour for Earth | Earth Hour](#) more information in the March Magazine on this one.



Bronze Eco Church Award Certificate

This is to certify that

All Saints Church Lawton

has won a Bronze Eco Church Award in recognition of their efforts to care for God's earth in each of the following areas (as applicable):

Worship and Teaching
Management of Buildings and Land
Community and Global Engagement
Lifestyle

Signed Andy Atkin Date 18 January 2025
CEO, A Rocha UK



ecochurch.arocha.org.uk
arocha.org.uk



From the Registers

Funerals

On 14th January Ann Kennerley Age 79 years

Memorial

On 17th January Meru Ullah Age 79 years

“The Lord is my shepherd, I shall not be in want. He makes me lie down in green pastures, he leads me beside quiet waters, Surely goodness and love will follow me all the days of my life, and I will dwell in the house of the Lord forever.”

(23rd Psalm)

Church Collections for November & December 2024

Week Beginning	3rd	£859.45	1st	£930.40
Week Beginning	10th	£1,030.55	8th	£1,379.16
Week Beginning	17th	£735.80	15th	£1,885.58
Week Beginning	24th	£191.75	22nd	£247.59
Week Beginning			29th	£173.84

Our thanks to everyone who has helped us by giving faithfully and generously towards our costs of mission, ministry and maintenance.

During this unprecedented challenging time, you can also keep up to date via our website where you can find out about our worship, church life, giving and accessing our monthly parish magazine.

Beetle Drive & Fish and Chip Supper

***Friday 21st February at
7pm***

All are welcome, you can come as a team or individual

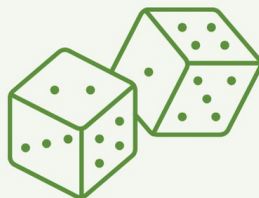

Beetle Drive 7pm to 8pm
Fish and Chips Bring your own bottle
Beetle Drive Final Rounds

All Donations to the
"Divine Relief" fund

All Saints' Church, Church Lane
Church Lawton ST7 3DD Tel 07473 355646
www.allsaintschurchlawton.co.uk
FB All Saints Church, Church Lawton



Laugh lines etcetera...

Visit

The new vicar was doing the rounds to meet his parishioners. At one house where he knocked, a woman inside called out: "Is that you, Angel?"

The vicar hesitated, and then replied: "No, but I'm from the same department."



Technically, the Parish Share is a voluntary contribution

Cow and choir

From a Cambridgeshire local newspaper in January 1900: 'WANTED – a steady respectable man who is able to look after a garden, milk a cow, and sing in the church choir.'

Chocolate

A lovely heart-shaped box of chocolates was received on Valentine's Day by a young student from her new boyfriend. On the enclosed card was the inscription: 'To Helen, with all my allowance.'

Those notices which didn't come out quite right...

Spotted in a safari park:

Elephants, please stay in your car.

In a Laundromat: Automatic Washing Machines. Please remove all your clothes when the light goes out.

This coming Sunday our special service will be gin at 11:00am.

This evening at 7:00pm there will be a hymn sing in the park across from the Church. Bring a blanket and come prepared to sin.

The King's Bras will present a concert at our church this evening at 6:00pm.

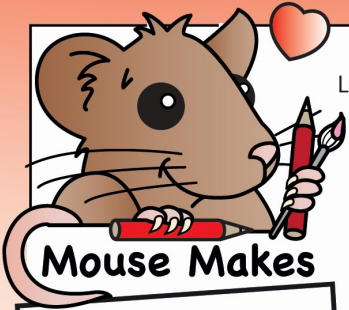

Mouse Makes

"Love is

love is _____,
 It does not, _____,
 it does not _____,
 it is not _____,
 it does not _____

others, it is not self-
 _____,
 it is not easily _____,
 it keeps no record of _____

Love delights in _____,
 it always _____,
 _____,
 _____,

from 1 Corinthians 13:4-7

The steadfast **love** of the Lord never _____;
 His _____ never come to an end;
 they are new every _____

Lamentations 3:20-23

I pray... you will understand...
 the greatness of Christ's **love**,

how _____
 and how _____
 and how _____
 that **love** is.
 Ephesians 3:18-19

God is **love**.
 whoever _____
 in **love** _____
 in God, and God _____
 _____ in them.
 1 John 4:16

Give _____
 to the Lord, for He is _____,
 his steadfast **love** _____
 endures _____

Psalm 136:1

HOW DOES
 GOD **LOVE** ME?
God sent me a saviour:
 He sent His one and only
 Son into the world so
 that we might have
 eternal life through Him.
 1 John 4:9
God gave me His spirit:
 He has given you the
 Holy Spirit to fill our hearts
 with His **love**.
 Romans 5:5
God called me His child:
 See what great **love** the
 Father has for us that He
 would call us His children.
 1 John 1:3

DID YOU KNOW?
 Jesus told us to:
LOVE the Lord your God with
 all your **heart**, all your **soul**
 and with all your **mind**.
 Matthew 22:37
LOVE your neighbour the
 same as you **love** yourself.
 Matthew 22:39

P T Y D E B P O P T E L T
 E R D L N M A Y R F D G R A
 A U G O D J T H O P E F U L
 C S K V U U I K T S F L T O
 E T P E R S E V E R E S H Y
 K I N D E T N B C S N L F A
 M N I Y S L T W T S D M U L
 I G R A C I O U S E S K L I
 H U M B L E S E L F L E S S

GOD • **LOVE**
 PATIENT • KIND
 GRACIOUS • PEACE
 JUST • TRUTHFUL
 TRUSTING • LOYAL
 HOPEFUL
 PERSEVERES
 ENDURES
 HUMBLE
 SELFLESS
 PROTECTS • DEFENDS

Recycling & Green Living Tips

Greening your lawn

A lawn on a sunny day is a place to socialise, relax and play. Some gardeners tend their lawns with passion, producing a perfect bowling green of short mown grass. Unfortunately when grass has been fed with fertiliser, treated with weedkillers and watered with sprinklers, it's bad for wildlife and bad for the environment.

Plastic grass is worse. It may offer a short-term, maintenance-free solution but environmentally it's one of the worst things you can put in your garden. Real grass captures carbon but artificial grass has a high carbon footprint. The wildlife value of fake grass is zero.

So how do we make our lawns more wildlife- and eco-friendly?

The ideal lawn should have areas of both short grass and long grass. A combination of the two increases biodiversity. Short grass is important as a feeding area for birds. Insects are easy for birds to find, and blackbirds, thrushes and robins can get to earthworms just below the surface of the soil. Short grass is also an important habitat

for mining bees. Shorter, mown grass near the house is better – for ease of access to facilities like washing lines and outdoor seating, and as a space for children to play. Short grass paths can also be mown through swathes of longer grass.



This can create a very attractive effect in larger spaces,

Care for your lawn by avoiding chemical fertilisers and weedkillers. Don't cut it too short during summer. Short grass tends to dry out more quickly in hot weather. Once a fortnight should be enough to keep it looking tidy. Try to avoid watering the lawn. Water is a precious resource, especially during droughts. Grass is extremely hardy. Even during prolonged dry spells it can survive and bounce back. While short grass is an important habitat, allowing some areas of grass to grow long – either a small patch or, if you have space, larger swathes – will really boost biodiversity. And the easiest way to do this is to simply stop mowing.

There are two ways to care for your long grass. For a spring meadow, only mow between July and late autumn. Or, for a summer meadow (which is great for attracting butterflies) stop mowing in April, then leave it alone completely until late September. Either method will create a haven for insects and other wildlife. And leaving patches of long grass means you spend less time mowing, and more time enjoying your garden!

A garden full of wildflowers, bees and butterflies should be something to be proud of and might encourage your neighbours to follow your lead, to create a community network of wildlife-friends.

So, what should you do instead of buying airfare offsets?

Fliers often think that offsetting your air miles is the way to green your air travel but that does not really work so what are the options?

Fly less -The first step is to be more aware of your travel. Sort your flights into those you need to take and those you don't.

Donate -if you can calculate the

carbon cost of the flights you take, donate that amount to a good cause

Travel light -If you must fly – pack lighter. This reduces your carbon footprint by lowering the plane's load and the fuel needed.

Here are ways to cut back on energy

1. Use cheaper kitchen appliances
The most energy efficient item is a slow cooker.

2. Only use your dishwasher when necessary. Cutting back to running it four times a week will save you £1.62 per week, or £84.24 every year.

3. Stop overfilling your kettle
Filling the kettle with more water than you need could be costing you an additional £10 per year in energy.

4. Stop leaving appliances on standby
You could save nearly £80 per year by switching things off after use.

5. Stop leaving curtains open after dark. As soon as the sun sets, close all curtains and blinds in your home. This will prevent warm air from escaping out of the windows.

Happy Recycling Carol Henshaw

All Saints' Community Page

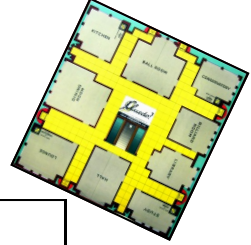

Fancy a game of Logo,
Dominoes, Rummikub, Snakes
and Ladders,
Ludo, Scabble or other games.

Tuesday 4th February
Then come and join us on
Enjoy a challenge or
teach others.

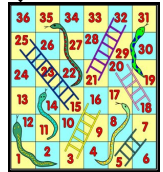
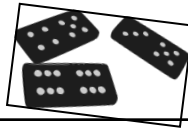
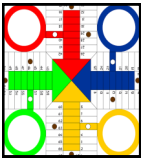
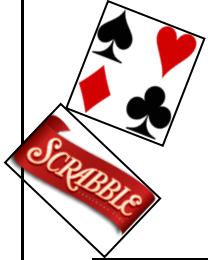

Diary Dates

Friday 21st February 7pm
Beetle drive and Fish and
Chip supper

Beetle Drive & Fish and Chip Supper
Friday 21st February at 7pm

All are welcome, you can come as a team or individual

Beetle Drive 7pm to 8pm
Fish and Chips Bring your own bottle
Beetle Drive Final Rounds All Donations to the
Diocese Relief Fund

All Saints' Church, Church Lane
Church Lorton, SY7 2JD Tel: 01473 200646
www.allstaints.org.uk
Rt Revd All Saints Church, Church Lorton

4th March Shrove
Tuesday Pancakes at the
Rectory time to be
confirmed



Morning Prayer time at All Saints'

Rev Sister Heather Kemball warmly invites you to join her for Morning Prayer at **9.30am on Monday, Wednesday and Friday from 6th January.**



Midweek Communion at the Rectory

Every Wednesday morning at 11am, on the first Wednesday of each month it will be followed by an informal lunch.

First Wednesday of each month at 6.30pm followed by an informal supper.



There are two 'special' days about books and reading: 1st February is 'Take your Child to a Library Day', and the 5th is 'World Read Aloud Day.'

A Book of Joy

Who knows what glee a book contains?
What joys we'll find as it explains
New facts to fill our hungry brains;
Or tells a lively tale?

The myst'ries that we will find
As we read books of ev'ry kind
Enlarge the borders of your mind?
A book will never fail!

The joy of words, which, crafted well
Can cast on us a magic spell
Marks upon a page which tell
Of worlds beyond our own!

Words which paint in vivid light
Rainbows in the dead of night
Which make our dull lives shine so bright!

The wonders we are shown!
So, find a library nearby
And help your child to find out why
The world is round, or why the sky
Is such a wondrous blue?

Or read a story, out aloud
Of lands beyond the madding crowd.
Try reading – it will make you proud
Of what a book can do!

By Nigel Beeton

All Saints' Church Lawton is open daily

The church is open daily for private prayer 10am to 3pm. Come in and spend a few quiet moments in the tranquil and peaceful setting. There is a prayer station at the front of the church or simply choose a pew.



Morning Prayer at All Saints'

Rev Sister Heather Kemball warmly invites you to join her for Morning Prayer at 9.30am on Monday, Wednesday and Friday from 6th January.

Midweek Communion at the Rectory

Every Wednesday morning at 11am, on the first Wednesday of each month it will be followed by an informal lunch.

First Wednesday of each month at 6.30pm followed by an informal supper.

Prayer Diary

Now available copies of the new monthly Prayer Diary with the names of all those on the electoral roll to enable us to pray regularly for one another.

Prayer for February

Dear Lord,

February can be a trying month, but there are special associations too and we thank you for the hope they bring.

In February we remember how Jesus was taken, as a baby, to the Temple. Simeon took Him in his arms and by the power of the Holy Spirit, recognised Him as the Saviour you had sent as a light, to bring revelation to the whole world. And how this world needs your light and revelation in this new year, 2025.

Lord – as we notice more light in the lengthening days of this month, as we see the promise of the Spring in the bobbing heads of the beautiful snowdrops – help us most of all to recognise Jesus as our Light and to trust in Him as our Lord and Saviour.

Thank you, Lord, for the gift of each new day. In Jesus' name.

Amen.

By Daphne Kitching

Bible Readings for February Services

Date	Epistle	Gospel
2nd	Hebrews 2: 14 - end	Luke 2: 22 - 40
9th	Isaiah 6: 1 - 8	Luke 5: 1- 11
16th	1 Corinthians 15: 12 - 20	Luke 6: 17 - 26
23rd	Revelation 4	Luke 8: 22 - 25

Teaser Answers

High-Rise Elevator

She is too small to reach the button for the 30th floor. She can only reach the button for the 20th floor. On rainy days, she's carrying an umbrella, enabling her to hit the button for the 30th floor.

Broken Down and Bankrupt

Answer – The man was playing Monopoly with his friends. His piece was the car, and he landed on the space with a hotel built on it. He didn't have enough money to pay the bill, so he was declared bankrupt

Weight Loss Miracle

Answer – The woman entered an elevator, descending to a lower floor. The acceleration of the elevator downwards meant she temporarily lost weight. After leaving the elevator, she gained the 20 pounds back.



Please send any material for inclusion in the March edition of Lawton Light! by February 10th

To Jane Baker
25 Dairylands Road,
Church Lawton, ST7 3EU
Telephone 01270 876363 or
email:
editor@allsaintschurchlawton.
co.uk

Services & Speakers February 2025

	8.30am	10.45am	6.00pm
2nd	Candlemass		
	Holy Communion	Holy Communion	Service of the Word
	Heather Kemball	Heather Kemball	Heather Kemball
9th	4th Sunday before Lent		
		Praise & Prayer	Holy Communion
		Margaret Cruxton	Margaret Cruxton
16th	3rd Sunday before Lent		
	Holy Communion	Holy Communion	Evening Prayer
	Heather Kemball	Heather Kemball	Heather Kemball
23rd	2nd Sunday before Lent		
		Praise & Prayer	Holy Communion
		Bev Boulton	Bev Boulton



February Rotas

Date	Time	Service	Readers	Prayers
2nd February	8.30am	Holy Communion BCP		
	10.45am	Holy Communion CW	Pat Lancaster Margaret Mellor	Bev Boulton
	6.00pm	Service of the Word	Harold Dowler Kieran Hutchinson	Bev Boulton
9th February	9.00am	Messy Church		
	10.45am	Praise & Prayer	Linda Jones Di Williams	Jane Baker
	6.00pm	Holy Communion CW	Chris Preston Kieran Hutchinson	Jane Baker
16th February	8.30am	Holy Communion CW		
	10.45am	Holy Communion CW	Bev Boulton Janet Parker	Alan Kemball
	6.00pm	Evening Prayer	Chris Preston Kieran Hutchinson	Harold Dowler
23rd February	10.45am	Praise & Prayer	Jane Baker	Yvonne Banks
	6.00pm	Holy Communion BCP	Ruth Griffiths Harold Dowler Chris Preston	Service prayers



Lawton Memorial Hall



Church Lawton
07432 739313



lawtonmemorialhall@gmail.com

www.lawtonmemorialhall.co.uk



www.facebook.com/LawtonMemorialHall



Odlum's Garage

Knutsford Road, Rode Heath
ST7 3SN

Sales, service, new & used parts,
body shop, MOT, diagnostic testing.
Saturday servicing

Tel: 01270-876226
kevinodlumsgarage@gmail.com



**Sharing the love of Jesus in
our Community**

Please follow the link to find out the many ways to donate to the upkeep of All Saints' Church Lawton
<https://allsaintschurchlawton.co.uk/giving-to-church/>



Jamie Osadnik
Your Local
OvenGleaner

Would you like your Oven, Range or AGA Gleaned?

"Jamie was on time & was very professional in my house, he was kind & very friendly. My oven is like brand new & I am very pleased with everything. I would have no hesitation in recommending OvenGleaners." Sarah R.

- ✓ Full Strip Down Clean
- ✓ Inclusive Pricing
- ✓ Fully Qualified & Insured
- ✓ Easy Call, Quote & Book
- ✓ All Makes & Models
- ✓ Safe For Children/Pets
- ✓ Safe For Asthmatics
- ✓ COVID SAFE CLEANING
- ✓ All Work Backed By Our Satisfaction Guarantee

Call Now: 01782 971915

 www.ovengleaners.com
★★★★★ Ovens | Ranges | AGAs | Hobs | Extractors | BBQs



LAWTON MANOR
BARCHESTER HEALTHCARE

Welcome to...
feeling right at home

There are lots of reasons to feel welcome at our home. From the choice of visiting options, to the delicious food and a commitment to truly celebrating life.

Call: 01270 861919
www.barchester.com
Church Lane, Church Lawton, ST7 3DD

**Residential Care • Nursing Care
Respite Care and Short Breaks**